

Model: SCD30-TLT
Titaha Surface
Downlight/Spotlight
Installation Instructions

superlux
we engineer light

IMPORTANT:
Install using a
Registered Electrician.
Isolate power supply.

- Decide the mounting position and feed the Supply cable through the Cable hole in the mounting plate.
- Fix the mounting plate to ceiling through the 3 holes using appropriate fasteners to secure to the mounting surface
- Attach Phase, Earth and Neutral wires to the terminal blocks as marked.
- Lift the Body and hook onto the Back plate, then secure in place with side screw.

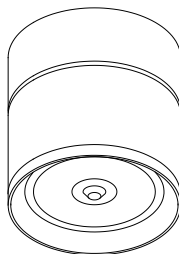

NOTE:

Do not Dismantle the LED body, No user serviceable parts inside.