

Model: F1600

GIRARE LANTERN HEAD

Installation Instructions



IMPORTANT: THESE LIGHT FIXTURES MUST BE INSTALLED BY A REGISTERED ELECTRICIAN. ISOLATE POWER SUPPLY BEFORE INSTALLING.

Lantern head only. Purchase pole or wall arm bracket separately.

IP65 Protection degree against dust ingress, solid particles, moisture.



Caution, risk of electrical shock. The lighting source of this luminaire must be replaced by the manufacturer only.



Insulation Class II

GENERAL MAINTENANCE RECOMMENDATIONS:

- Clean the luminaire periodically to remove possible dirt/ground deposits.
- Do not use harsh detergents to clean the diffuser.

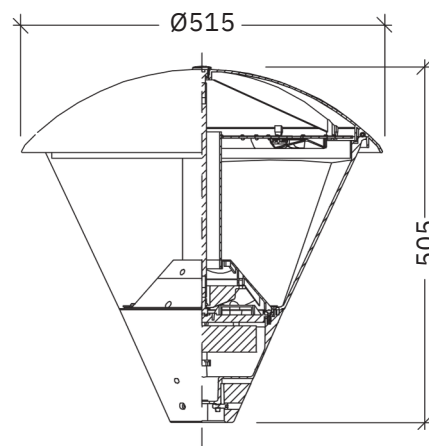

INSTALLATION INSTRUCTIONS:

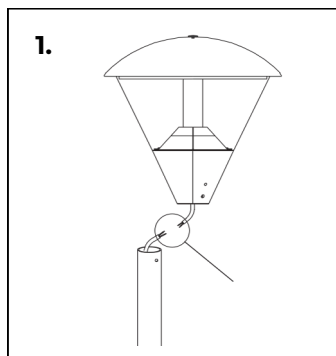

1. For a safe and correct installation, ensure a water tight connection between the supply cables.

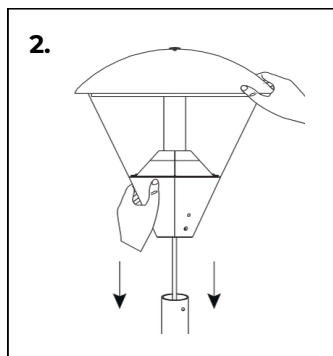

2. Place lantern head on top of pole or wall bracket.

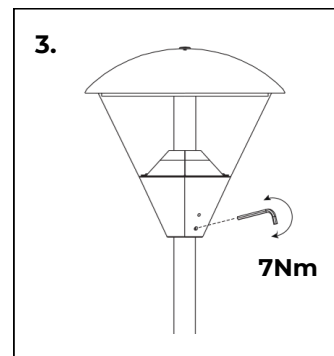

3. Fix the light to the pole or wall bracket FB3003. Check that the screws that secure the luminaire to it's support (pole/bracket) are tightened securely.

IMPORTANT: KEEP INSTRUCTION SHEET IN A SAFE PLACE FOR FUTURE REFERENCE.